

## Light Rolltalk accessories:

See [www.falckigel.no](http://www.falckigel.no)



Table stand for  
Light Rolltalk



Daessy wheelchair stand



Wheelchair stand for  
Light Rolltalk



Battery pack with converter

# LIGHT ROLLtalk



Buddy switch  
See other switch  
solutions



Rolltalk control module  
for electric wheelchairs



Neck support with switches:  
Neck support Stealth SU300,  
Switch fitting SUS9-B,  
Egg switch



Head mouse Tracker Pro



Web camera



Finger guide for Rolltalk



USB Thumb Drive  
for backup



## Technical specifications



Buvikveien 22, N-4950 RISØR, NORWAY  
Tel.+47 3714 9450 • Fax +47 3714 9470  
Website: [www.falckigel.no](http://www.falckigel.no)

# Light Rolltalk technical specifications

Light Rolltalk is a portable speech and environmental control aid with a dynamic display.

## The Light Rolltalk pack contains:

- Rolltalk Workshop 6 software
- Windows XP Professional
- Wireless LAN (Internet) and Bluetooth
- Add-on module including:
  - IR-transmitter, (accessory)
  - Wireless switch receiver
  - Switch inputs
  - Output for audio scanning
  - Output for Rolltalk control module for electric wheelchairs
  - Extra loudspeaker input for audio scanning
- Charger and internal battery
- Microphone, mouse, keyboard and pen
- Instruction manuals

### Right-hand side:

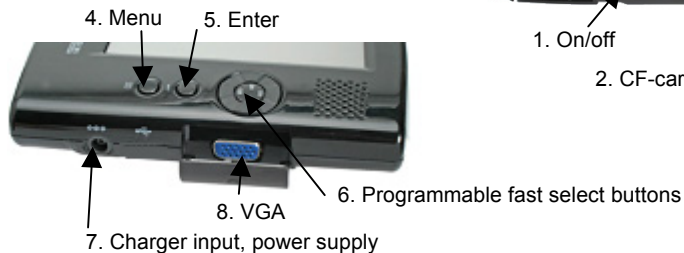

### Top:

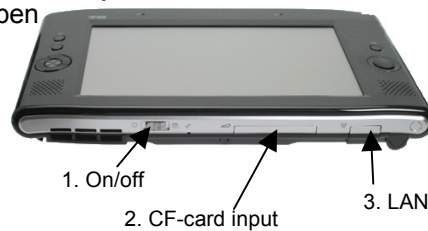

### Right-hand side with module:

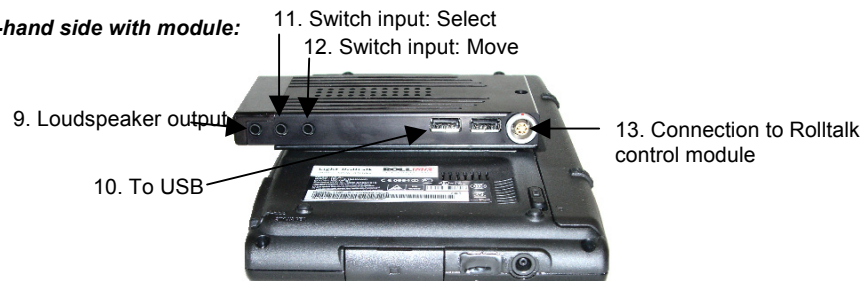

## Technical specifications

Processor:	Intel Celeron 900 MHz
RAM:	512 MB
Hard drive	40 GB
Operating system:	Windows XP Professional
Power consumption:	approx. 2 hours on internal battery
Screen	800x480 active matrix (can simulate other modes)
Size	7"
Storage temp.	- 20 - + 50C
Use temp.	-10 - + 40C
Humidity	30–70% relative humidity (non-condensing)
External dim.	29 x 22 x 2.7 (4.4 thickest) cm
Weight	970 g (incl. module)

CD-ROM, mouse, microphone and keyboard can be connected via USB.

## Cleaning

Use screen cleaner to clean the screen surface, or wipe it with a cloth moistened in mild soapy water.  
NB! Make sure the cloth is not too wet when wiping the screen.

## Shipping Light Rolltalk

If you need to send the Rolltalk unit in for upgrade or repair, make sure to package it securely. Ideally, use a specially padded box.

## Start-up

Use the on/off button (1) to switch the machine on (1).

Light Rolltalk is supplied with Windows XP and Rolltalk Workshop installed.

Connect the mouse and keyboard (and microphone, if any) to work with user-adaptations.



Light Rolltalk can start up with user adaptations (see the Rolltalk Workshop instruction manual). When the user programme is running, press the “pause” key to switch to programming mode, or press the “Esc” key to access the Windows desktop.

See the Rolltalk Workshop instruction manual for information about how to adapt user programs.

When you are working in programming mode in Rolltalk Workshop, you may occasionally have to alter the screen resolution if some windows become too large.

### Temporary alteration of the screen resolution:

When editing in Rolltalk Workshop, the Light Rolltalk screen resolution should be altered so that you can access all windows. To alter the screen resolution, use the little black button on the left-hand side of the screen.

To change the screen resolution:

1. Start the program “1.bat”, which you will find on the desktop
2. Close the command window that appears
3. Use the button on the left-hand side to change the screen resolution to either 800 x 600 or 1024 x 600
4. Start the program “2.bat”, which you will find on the desktop
5. Click “OK” in the message box that is displayed on the screen
6. Close the command window that appears

## Charging and power supply

To charge Light Rolltalk, connect the charger supplied to a mains socket. Plug the charger connector into the power supply input (7).

You can use Light Rolltalk while it is being charged.

Light Rolltalk can operate for approx. 2 hours when fully charged.

### Check the battery level

Turn off the machine, remove the battery and then press the button marked “Push”

### Power supply to electric wheelchairs

If you are using Light Rolltalk on an electric wheelchair, you can draw power from the wheelchair batteries.

Light Rolltalk can be connected to the batteries through an adapter. This ensures connection to a power supply all day.

*Item no. 000176: converter to Light Rolltalk - electric wheelchair.*

### External battery pack

If you are using Light Rolltalk on a manual wheelchair, we recommend that you fit a battery pack to ensure an all-day power supply.

*Item no. 000381 Battery pack with converter to Light Rolltalk*

## USB

These ports are designed for external accessories with USB plugs. You can use them to connect equipment such as CD-ROM units, Web cameras, and USB discs for backing up own programs and images.

USB ports can also be used to connect a microphone, mouse and keyboard, as well as some control units, such as a headmouse.

### Switch inputs

Operating switches can be connected to the switch inputs for “Move” (11) and “Select” (12). Alternatively, you can use wireless switches. See the separate instruction manual for wireless switches.

Loudspeaker output for audio scanning (9)

Output for audio scanning (the options on the screen are read aloud to the user – via an earpiece, for example).

## Remote control IR (environment control)

Environmental control is an accessory for Light Rolltalk. If you have ordered environmental control, this will be built into the loudspeaker and switch control module.

The environmental control/remote control function is teachable, and IR commands can be programmed and transmitted via Rolltalk Workshop. Most of the equipment that can be operated via a remote control unit can also be operated via Rolltalk.

See the Rolltalk Workshop instruction manual for details of how to set up IR functions.

## Electric wheelchair operation

Light Rolltalk can be used to operate an electric wheelchair and adjust the seat position. To access these functions, you need to connect a Rolltalk control module (item no. 120). The control module can be connected to the appropriate port (13).

## Mobile phones and Light Rolltalk

By connecting a mobile phone to Light Rolltalk, you can send and receive text messages. These messages can be written using both text and pictures. If you have installed a synthetic speech program, incoming text messages can be read aloud.

Bluetooth for mobile phones is built into Light Rolltalk.

See the Rolltalk Workshop instruction manual.

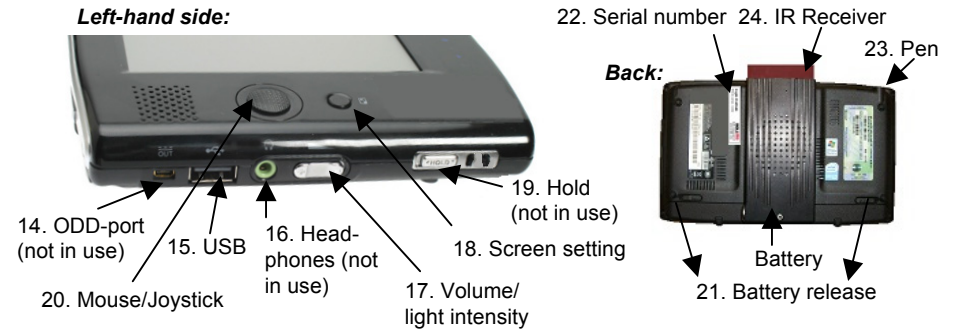

1. On/off. Turn the switch to the right and release to switch the unit on or off
2. Slot for CF-card.
3. LAN network port for connection to the Internet. A wireless network (Wireless LAN) connection is built into the unit, as is Bluetooth for connecting a mobile phone.
4. Menu button. Provides access to a menu, from which you can switch networks on/off, adjust the volume and light settings and even rotate the screen. (See the "readme" file on the desktop for information about how to activate this option.)
5. Enter. Activates the field(s) selected on the screen.
6. Programmable fast select buttons. You can program these button to operate programs and key combinations you use regularly.
7. Charger/power supply (mains power, wheelchair, battery pack). It is important that you only use own power supply and adapters specially designed for Light Rolltalk.
8. VGA. Connection to an external screen.
9. Loudspeaker output
10. 2 x USB – used for connecting a range of equipment.
11. Input for standard switch (jack) with SELECT function
12. Input for standard switch (jack) with MOVE function
13. Connection to Rolltalk control module for operating an electric wheelchair
14. External ODD-port. (ODD is an optional accessory, and this port is not in use)
15. USB. Used for connecting a range of equipment: for example, a mouse, microphone, or keyboard
16. Headphones input (not in use)
17. Volume control/light intensity. To adjust the light intensity on the screen, keep the menu button (4) depressed and use the volume/light intensity control (17).
18. Screen setting. Stepped adjustment of the screen resolution (800 x 480, 800 x 600 or 1024 x 600). (See the "readme" file on the desktop to activate this option)
19. Hold (not in use).
20. Mouse/joystick. Has the same function as the arrow keys on the keyboard.
21. Battery. To release, push both buttons out towards the edges of the machine.
22. Serial number (state this number when contacting customer service, etc.)
23. Pen for programming.